

# Building a virtual 3D City model for Brandenburg

an ERDF-financed project of  
State Survey and Geospatial Basic Information Brandenburg(LGB),  
Germany



## The product and its qualities



By means of ERDF in 2013 a data set of 3D buildings was built up in Brandenburg (federal state of Germany).

what to expect:

- Level of Detail 2 (LoD 2) = block model with standard roof forms (here: decomposition into sub-areas from 20 sqm)
- derived from current aerial photos resp. laser scan data
- based on official building outlines
- presented on a high quality terrain model
- possibility to texturize the terrain
- export in current file format cityGML, VRML, 3D PDF, 3D Shape, 3D DXF, KML...

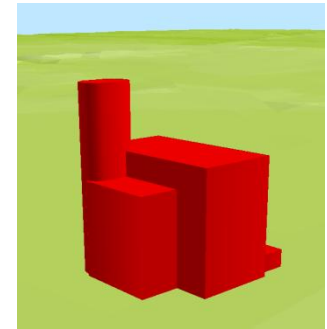

LoD 1

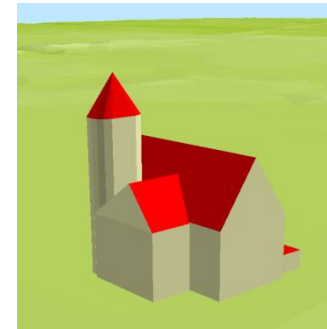

Level of Detail (LoD) 2



LoD 3

## Availability, costs, usage

Within this ERDF project, the **surrounding area** of Berlin as well as the **bigger cities** (> 20,000 inhabitants) have been modeled.

About 41% of a total of 2.5 Mio buildings in Brandenburg are currently available.

The aim is a **complete availability** in 2017 and a **continual update** of the data set.

- distribution through Geobroker: planned for 2014
- web-based geo-service (WebFeatureService)
- user fee: determining in 2014

Opportunities for using are given e.g. in the context of **local planning**, **solar potential analysis**, noise mapping, **visibility analysis**...

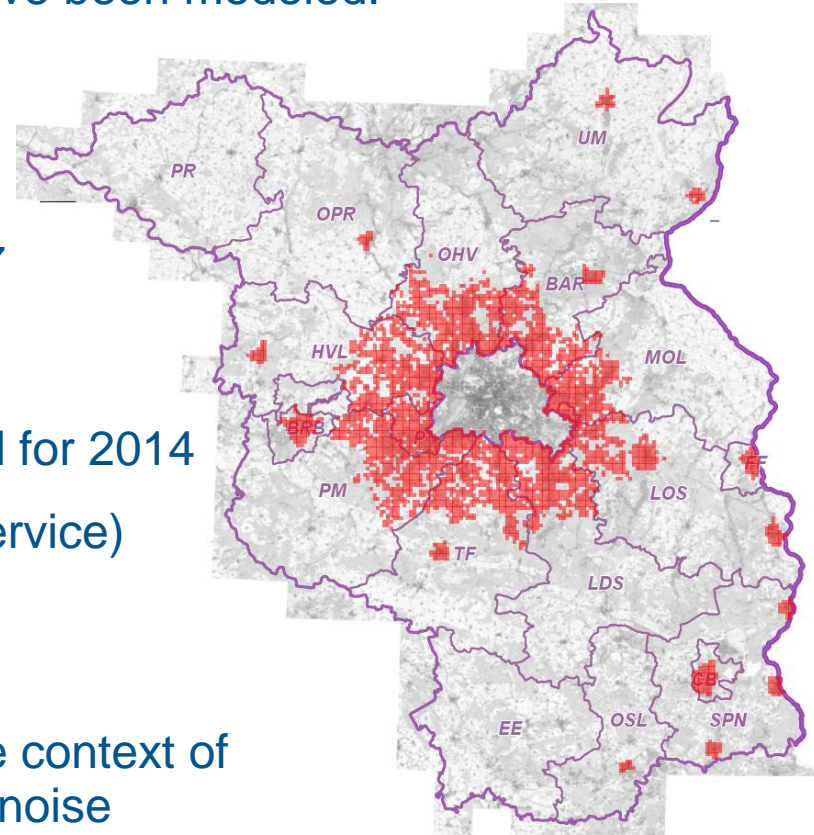

Thank you for your attention!



Landesvermessung und Geobasisinformation  
Brandenburg  
Heinrich-Mann-Allee 103  
14473 Potsdam  
GERMANY

Tel. +49 331 88 44 – 123  
kundenservice@geobasis-bb.de

<http://www.geobasis-bb.de/>